

# 2026 Spruce Meadows 'PAN AMERICAN' CSI 5\*

Presented by ROLEX

Jun. 24-28, 2026

Class No.: 537 WEST CANADIAN CUP - presented by WCD

Competition with one jump-off

Table: A

Speed: 400 m/min

Obstacles: 13

Jump-off: **10-11a-8a-8b-1-2-3-15-16**

Length: 0 m

Efforts: 16

Length: 390 m

FEI RG / Art. 220.2.1.2

Time allowed: 0 sec

Time allowed: 59 sec

Height: 1,45 m

Time limit: 0 sec

Time limit: 118 sec



Sunday June 28th, 2026

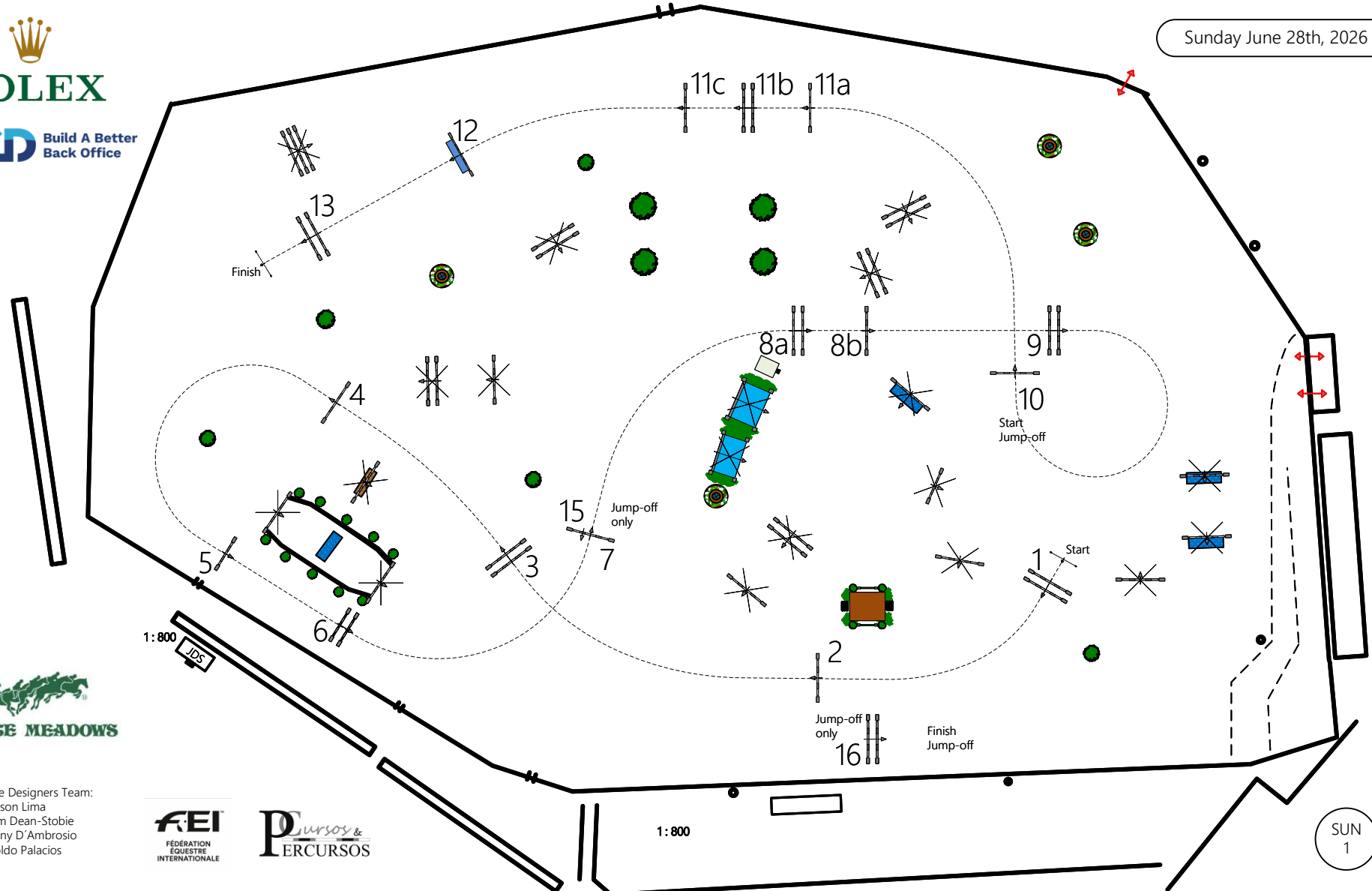

Course Designers Team:  
Anderson Lima  
William Dean-Stobie  
Anthony D'Ambrosio  
Leopoldo Palacios



1:800

SUN  
1