

CSI 2* - 5* 'MASTERS' - SPRUCE MEADOWS

SEPTEMBER 1-7, 2025

Competition No.: 801

Table: A
National RG:
FEI RG / Art. 238.2.1
Height: 1,10 m

Friends of the Meadows Jumper - 1.10m

Speed: 350 m/min
Length: 480 m
Time allowed: 83 sec
Time limit: 166 sec

Obstacles: 1 - 11
Efforts: 13
Penalty sec: no
Closed combination: no

Competition against the clock

1st Jump-off: no
Length: 0 m
Time allowed: 0 sec
Time limit: 0 sec

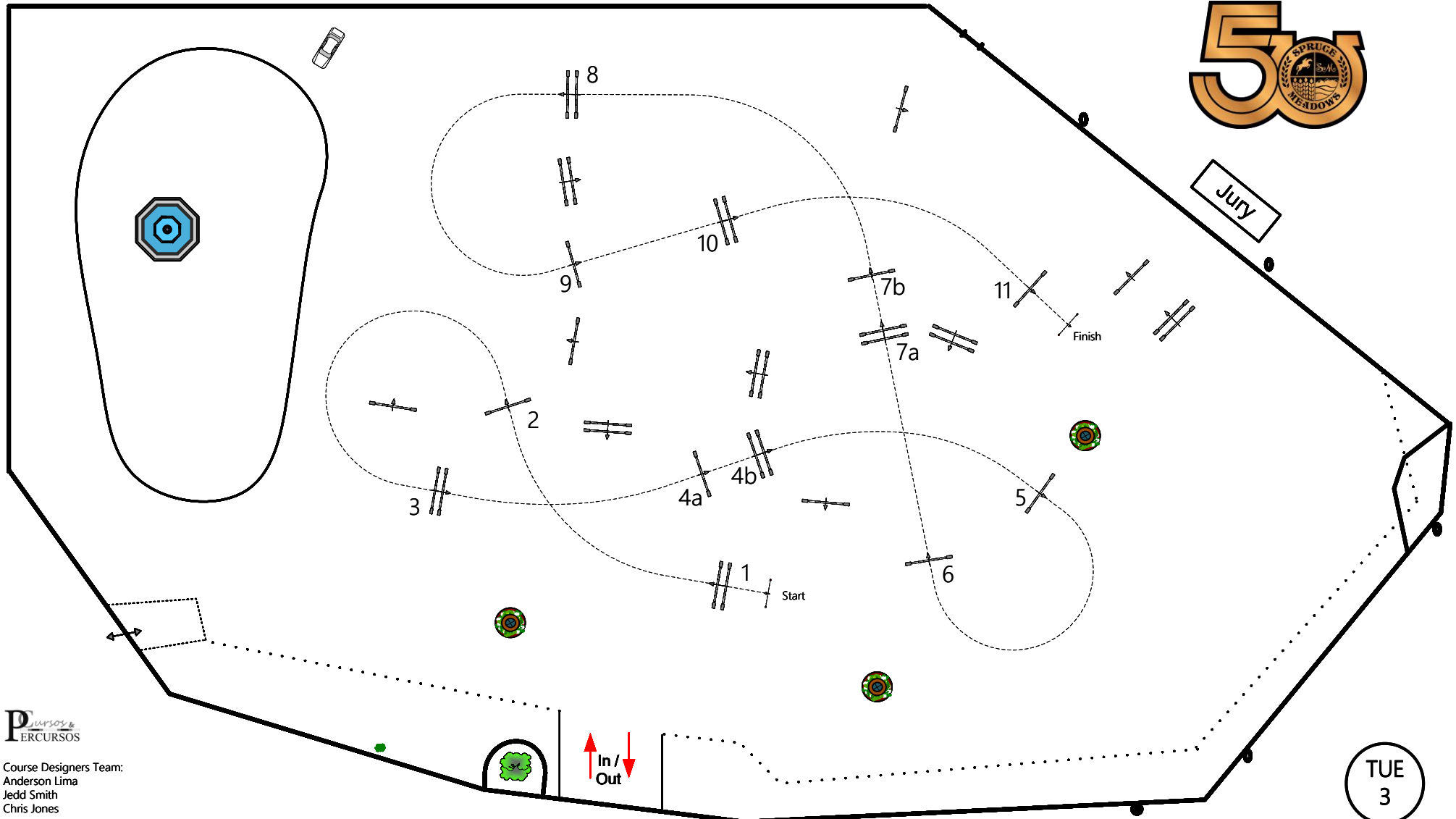

Percursos & PERCURSOS

Course Designers Team:
Anderson Lima
Jedd Smith
Chris Jones

Cursos e Percursos Eventos Ltda. This course plan and / or technical measurements may not be copied, published, distributed or digitally transferred without specific written permission of the responsible course designer.